

***lava***



parijsstraat 74 B-3000 leuven

[www.lav-a.eu](http://www.lav-a.eu)

[info@lav-a.eu](mailto:info@lav-a.eu)

t. + 321016.23.01.41

f. + 321016.22.13.91

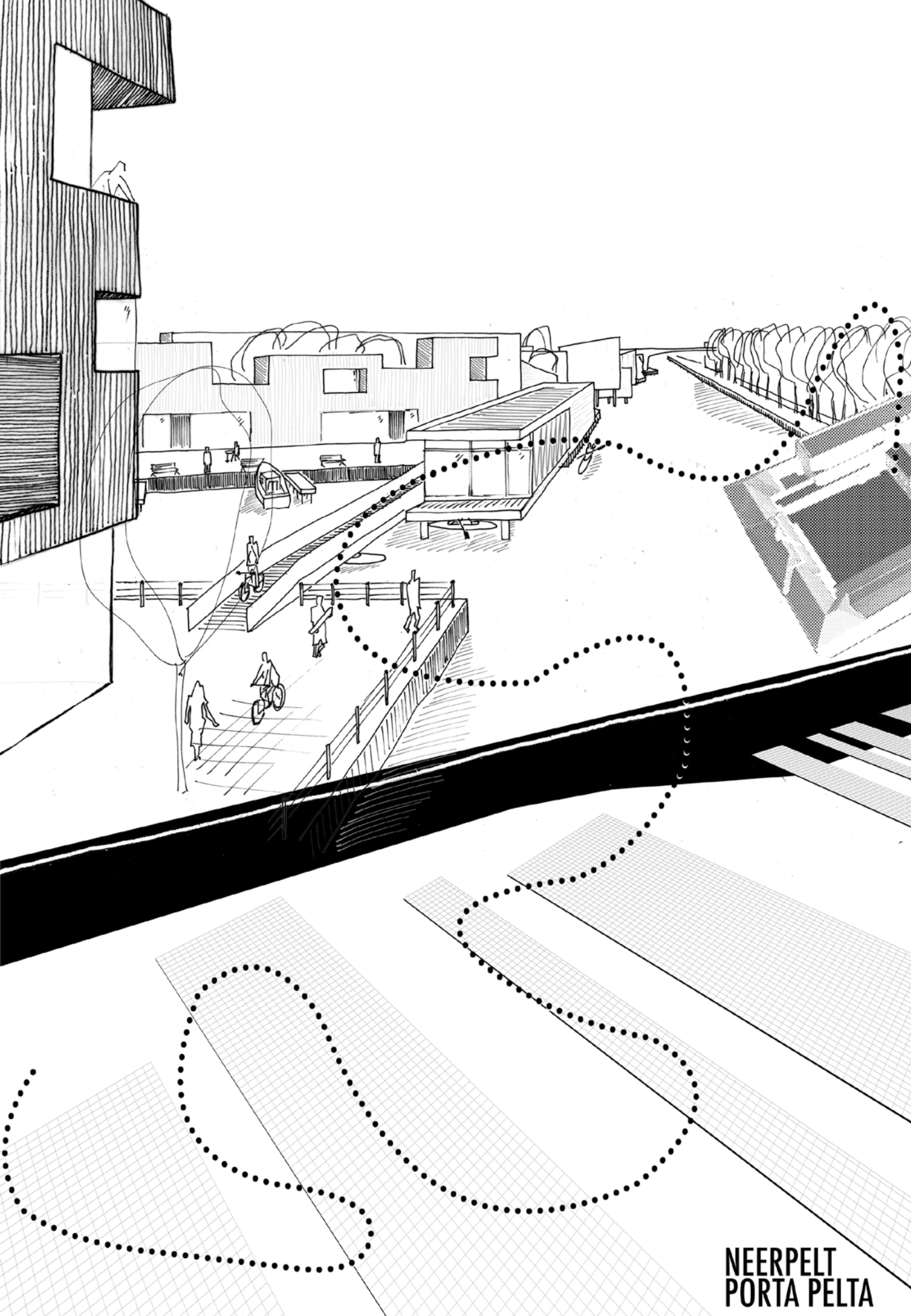

NEERPELT  
PORTA PELTA

toekomst BEELD  
BEELD vorming  
BEELD bepalend  
voor BEELD  
na BEELD  
BEELD houwen  
BEELD kwaliteit  
ver BEELD  
stand BEELD  
BEELD materiaal  
BEELD spraak  
toon BEELD  
BEELD element  
schaduw BEELD  
tegen BEELD  
BEELD waarde  
BEELD verhaal  
gevel BEELD  
archieff BEELD  
totaal BEELD  
tijd BEELD  
BEELD en  
BEELD gedicht  
BEELD regie  
sfeer BEELD  
oer BEELD  
droom BEELD  
denk BEELD  
BEELD bewerking  
BEELD drager  
BEELD rijk  
BEELD mooi  
BEELD verwerking  
straat BEELD  
mode BEELD  
mens BEELD  
kleuren BEELD  
klank BEELD  
eind BEELD  
BEELD verslag  
BEELD vullend







**Objectieve analyse**  
(densiteit en grondgebruik)



**Subjectieve analyse**  
(foto's)

bouwblok nr	opp bouwblok	opp bebouwing	V/T	arcering	#bouwlagen	arcering	B/T	arcering	bezetting/ha	#wo/ha	#woningen
1	288	288	100%	10	4	8	400%	10	40000	333	9,6
2	388	388	100%	10	4	8	400%	10	40000	333	12,9
3	3440	1658	48%	5	4	8	193%	7	19279	161	55,3
4	3065	1093	36%	4	4	8	143%	5	14264	119	36,4
5	2677	1988	74%	8	4	8	297%	10	29705	248	66,3
6	801	636	79%	8	3	6	238%	8	23820	199	15,9
7	4717	2213	47%	5	3	6	141%	5	14075	117	55,3
8	9979	2036	20%	3	4	8	82%	3	8161	68	67,9
9	10994	1406	13%	2	3	6	38%	2	3837	32	35,2
10	5679	2151	38%	4	3	6	114%	4	11363	95	53,8
11	6673	3162	47%	5	3,5	7	166%	6	16585	138	92,2
12	1651	1392	84%	9	2,5	5	211%	8	21078	176	29,0
13	5664	1602	28%	3	3	6	85%	3	8485	71	40,1
14	12260	3356	27%	3	3	6	82%	3	8212	68	83,9
15	9459	2088	22%	3	2	4	44%	2	4415	37	34,8
16	6087	922	15%	2	2	4	30%	2	3029	25	15,4
17	6508	1666	26%	3	2	4	51%	2	5120	43	27,8
18	5464	1236	23%	3	2,5	5	57%	2	5655	47	25,8
19	3247	749	23%	3	3	6	69%	3	6920	58	18,7
20	3452	1032	30%	4	3	6	90%	4	8969	75	25,8
21	2336	1029	44%	5	2	4	88%	3	8810	73	17,2
22	9967	1581	16%	2	2	4	32%	1	3172	26	26,4
23	3598	846	24%	3	2	4	47%	2	4703	39	14,1
24	5362	607	11%	2	2	4	23%	1	2264	19	10,1
25	3077	5	0%	1	3	6	0%	1	49	0	0,1
26	3134	593	19%	2	2	4	38%	2	3784	32	9,9
27	14180	1770	12%	2	2	4	25%	1	2496	21	29,5
28	5862	711	12%	2	2	4	24%	1	2426	20	11,9
29	15438	2170	14%	2	2	4	28%	1	2811	23	36,7
30	1557	463	30%	4	2	4	59%	2	5947	50	
31	6679	704	11%	2	2	4	21%	1	2108		
32	2870	840	29%	3	2	4	59%				
33	3728	705	19%								
34	9631	1453	15%								
35											
36											







**Objectieve analyse**  
(densiteit en grondgebruik)

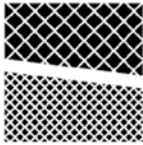

**Stellingname**  
(landschap vs stedelijkheid)

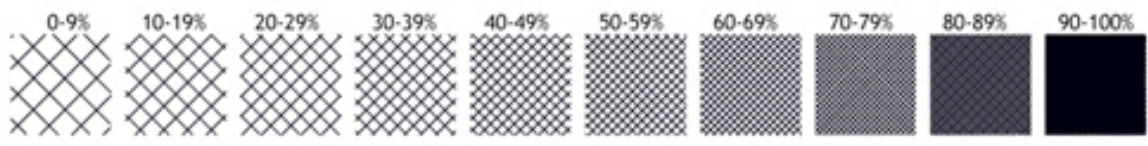
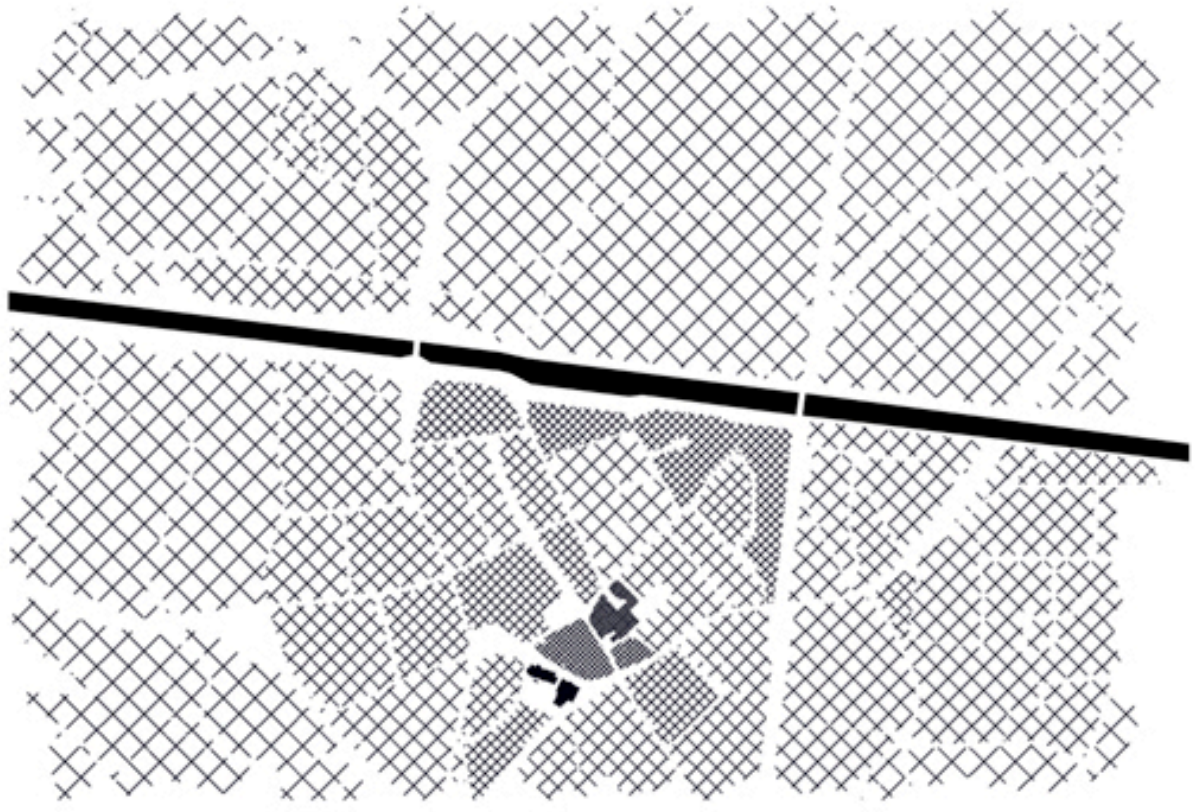
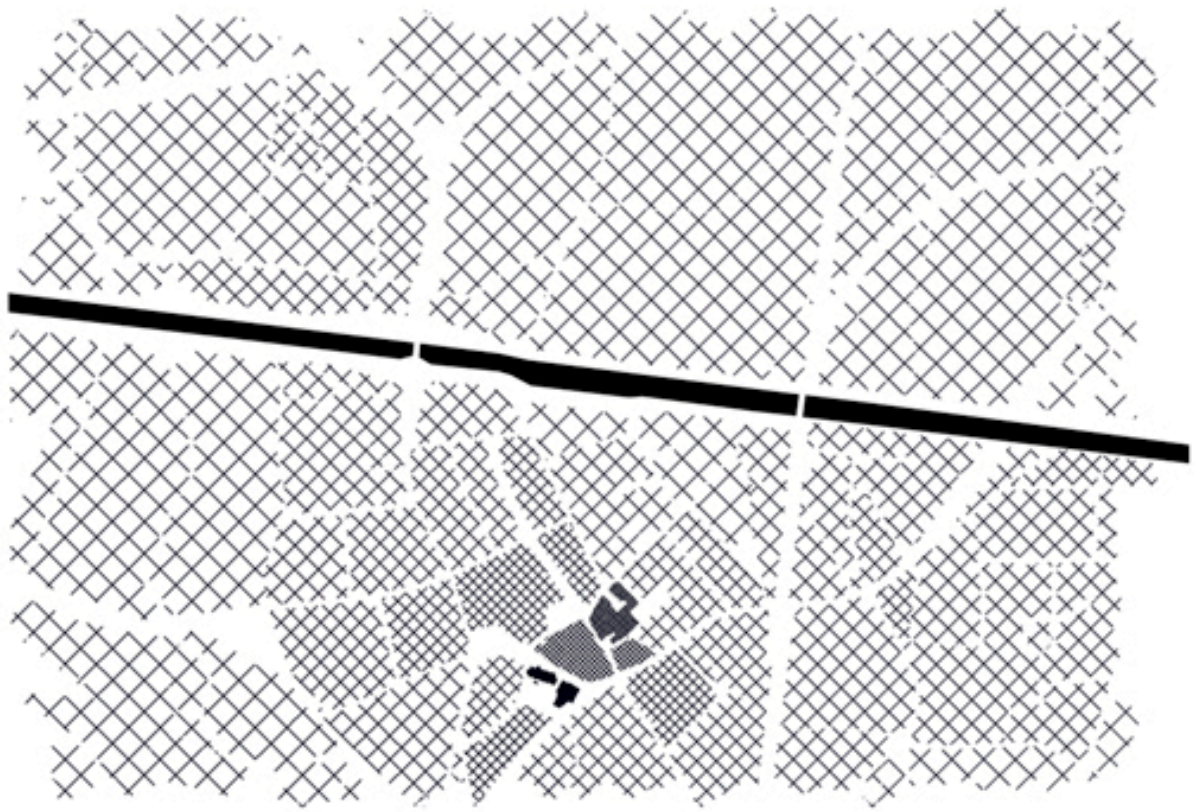



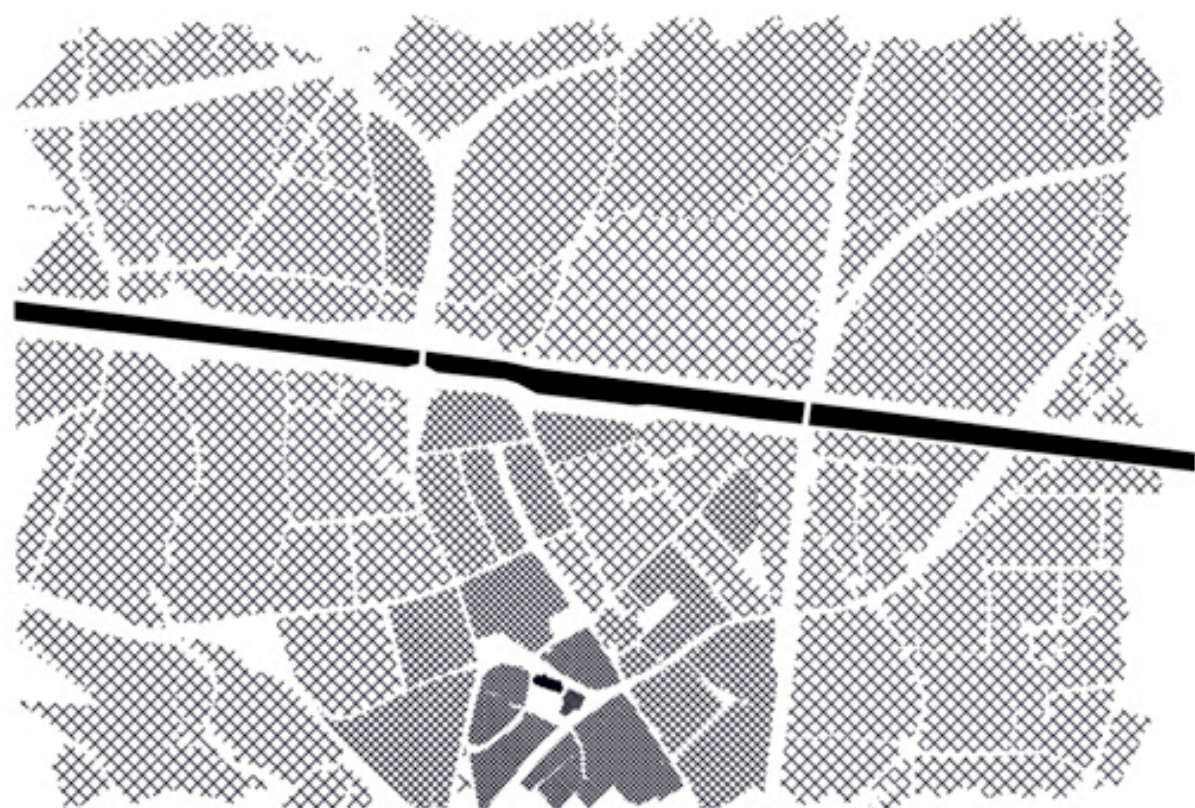







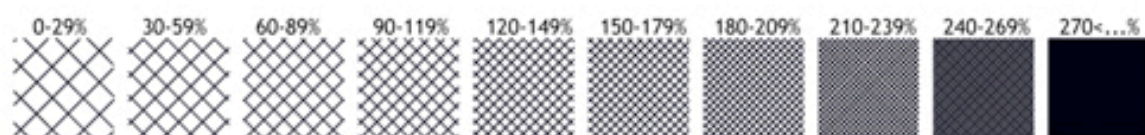
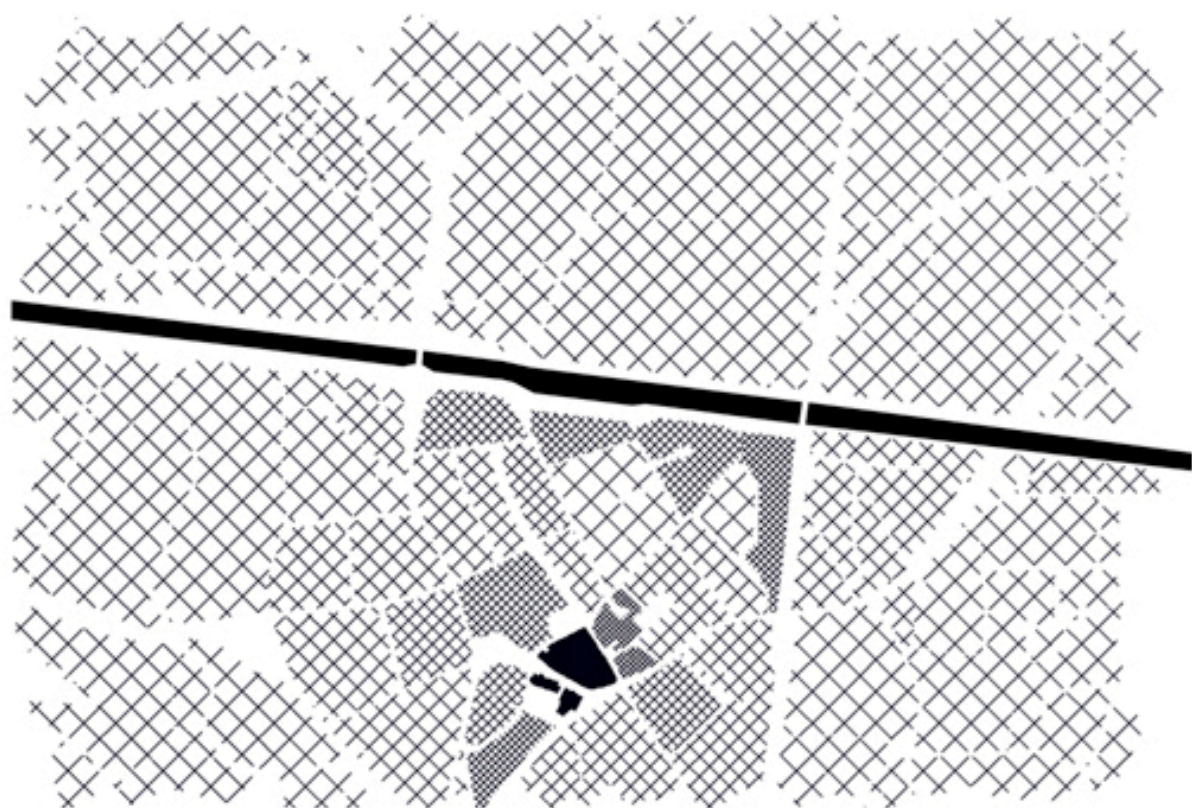
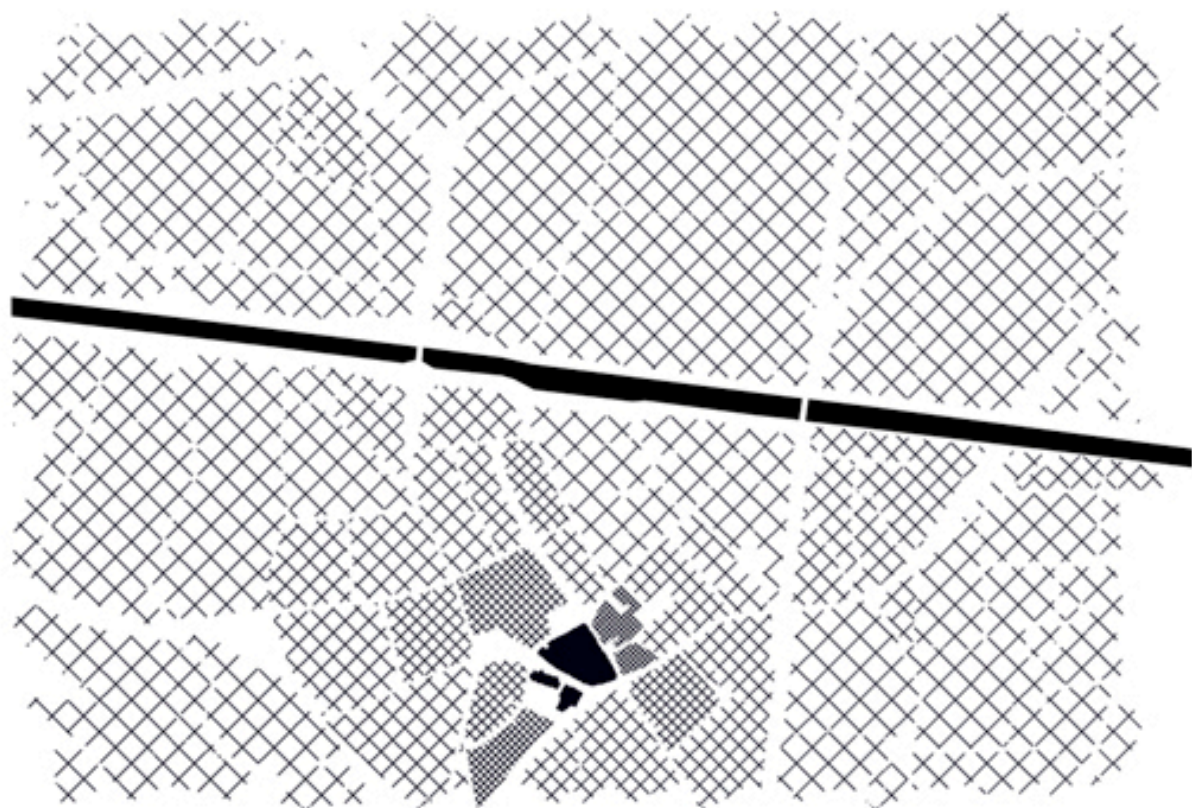







**Ruimtelijke strategie**  
(stip vs strip)





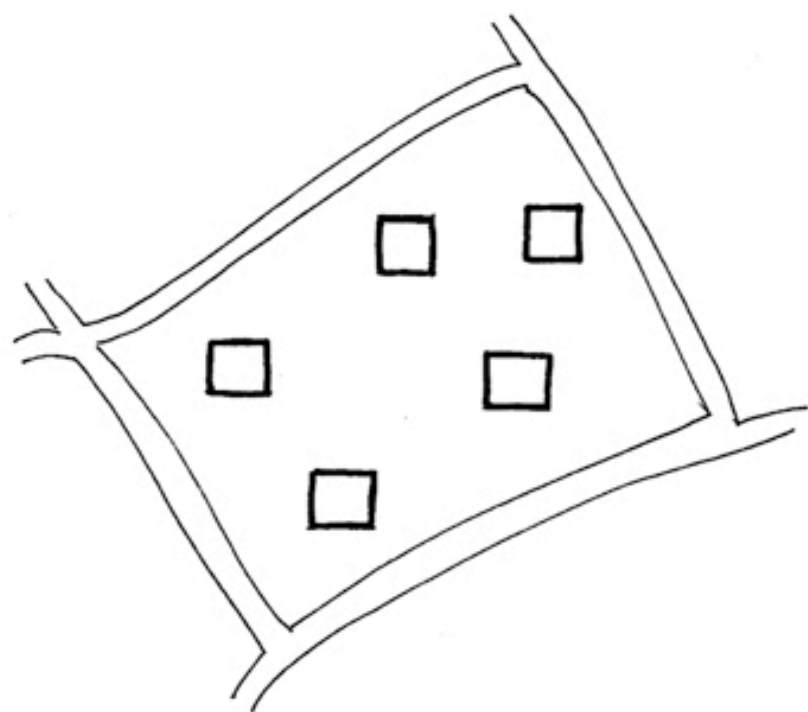
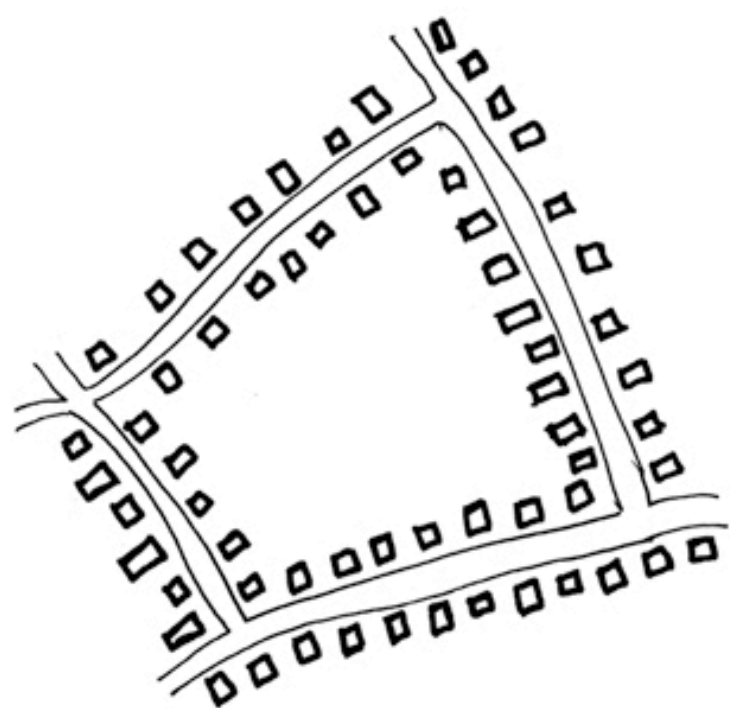

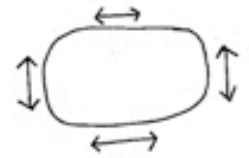
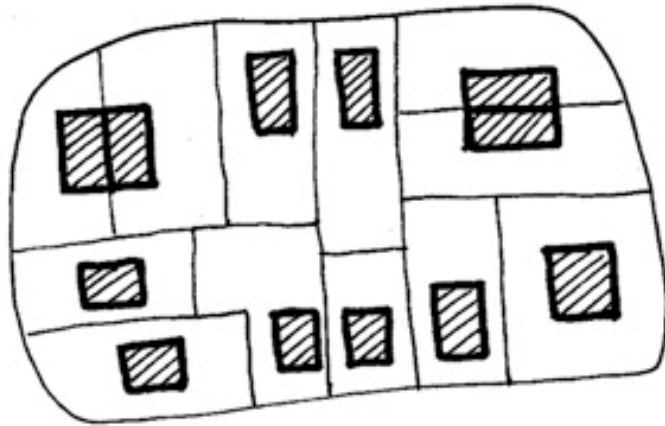

PUBLIEK  
PRIVAAT

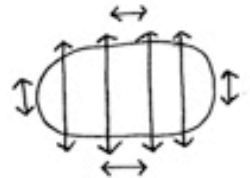
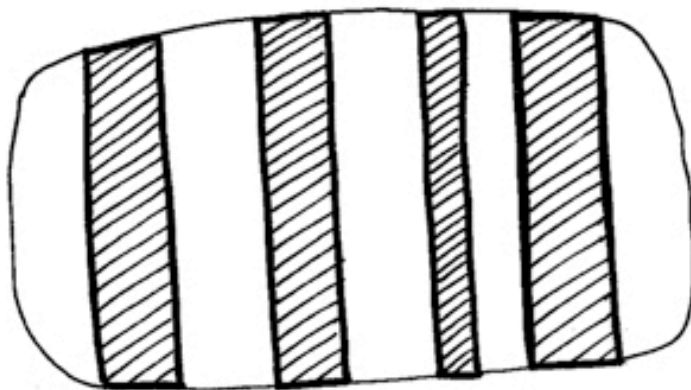

SEMI PUBLIEK  
PRIVAAT





















**Instrumentarium**  
(beheersconstructie vs matrix)



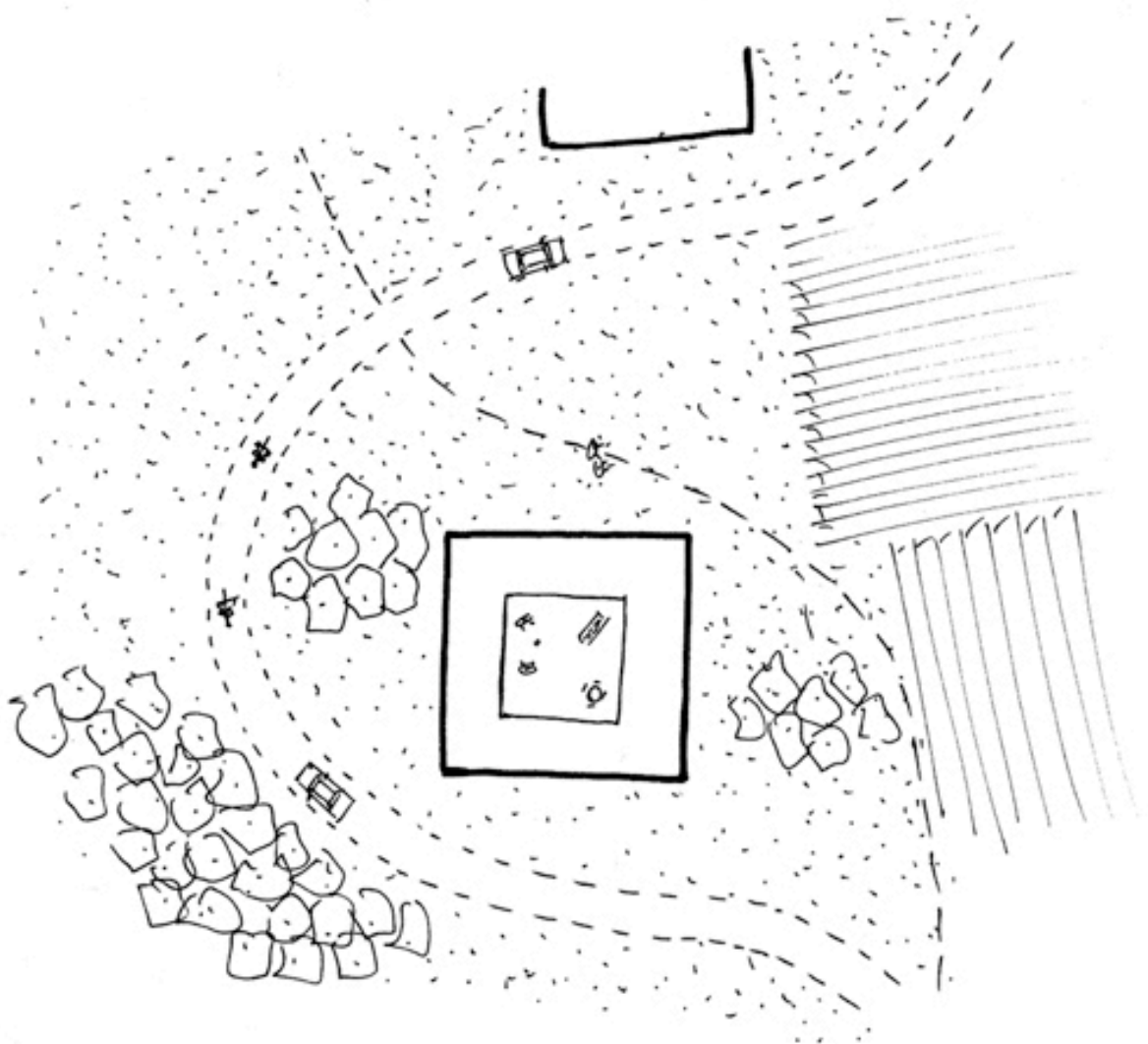

STEDLIJK

LOKAAL

VERHARD

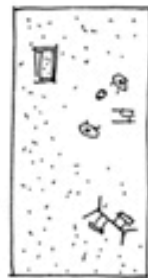
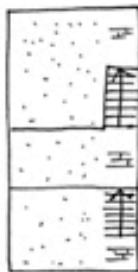
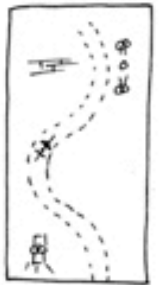
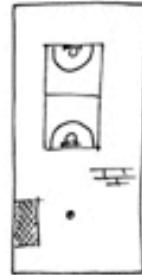
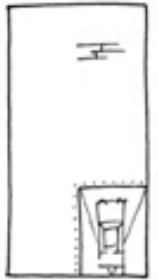
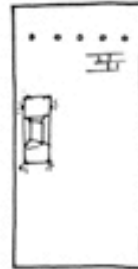
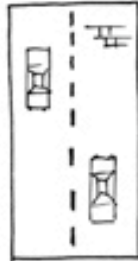
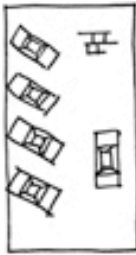

GROEN

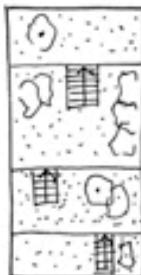
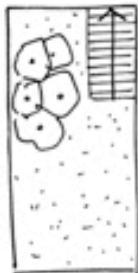





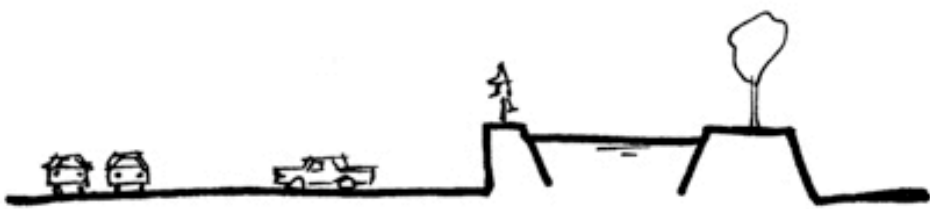
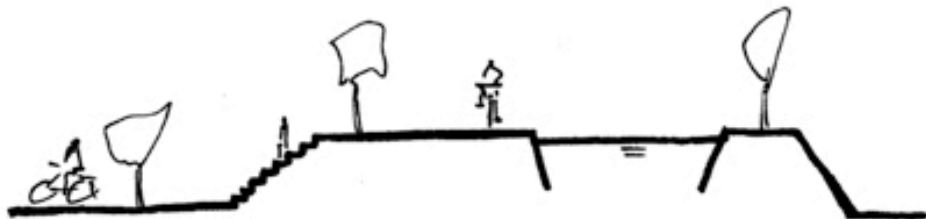
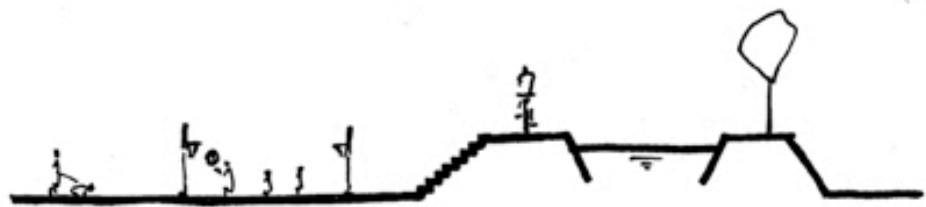



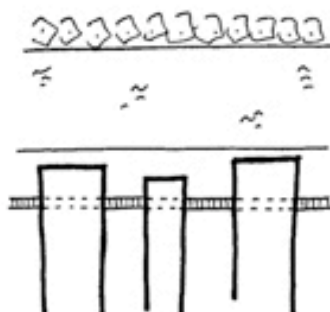
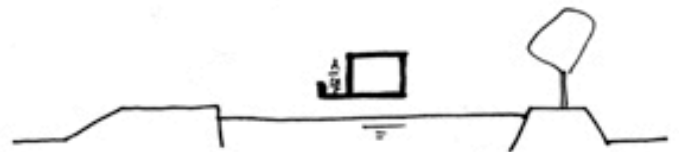
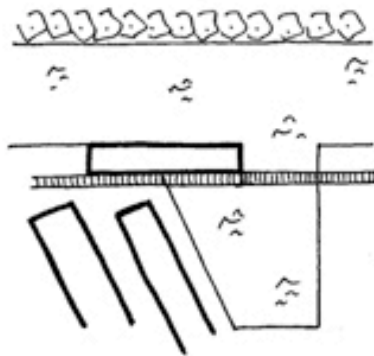
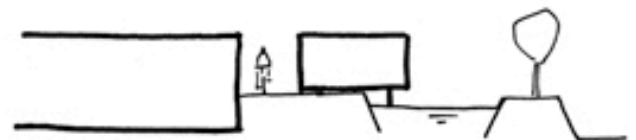
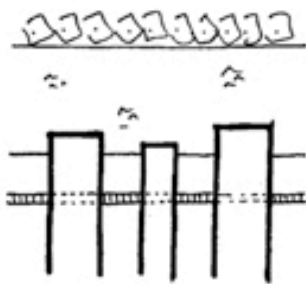
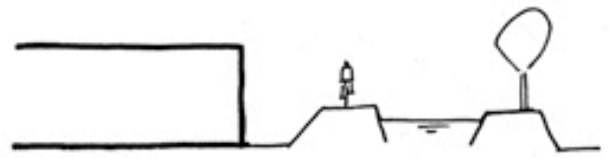







**Eindbeeld**  
(perspectief)

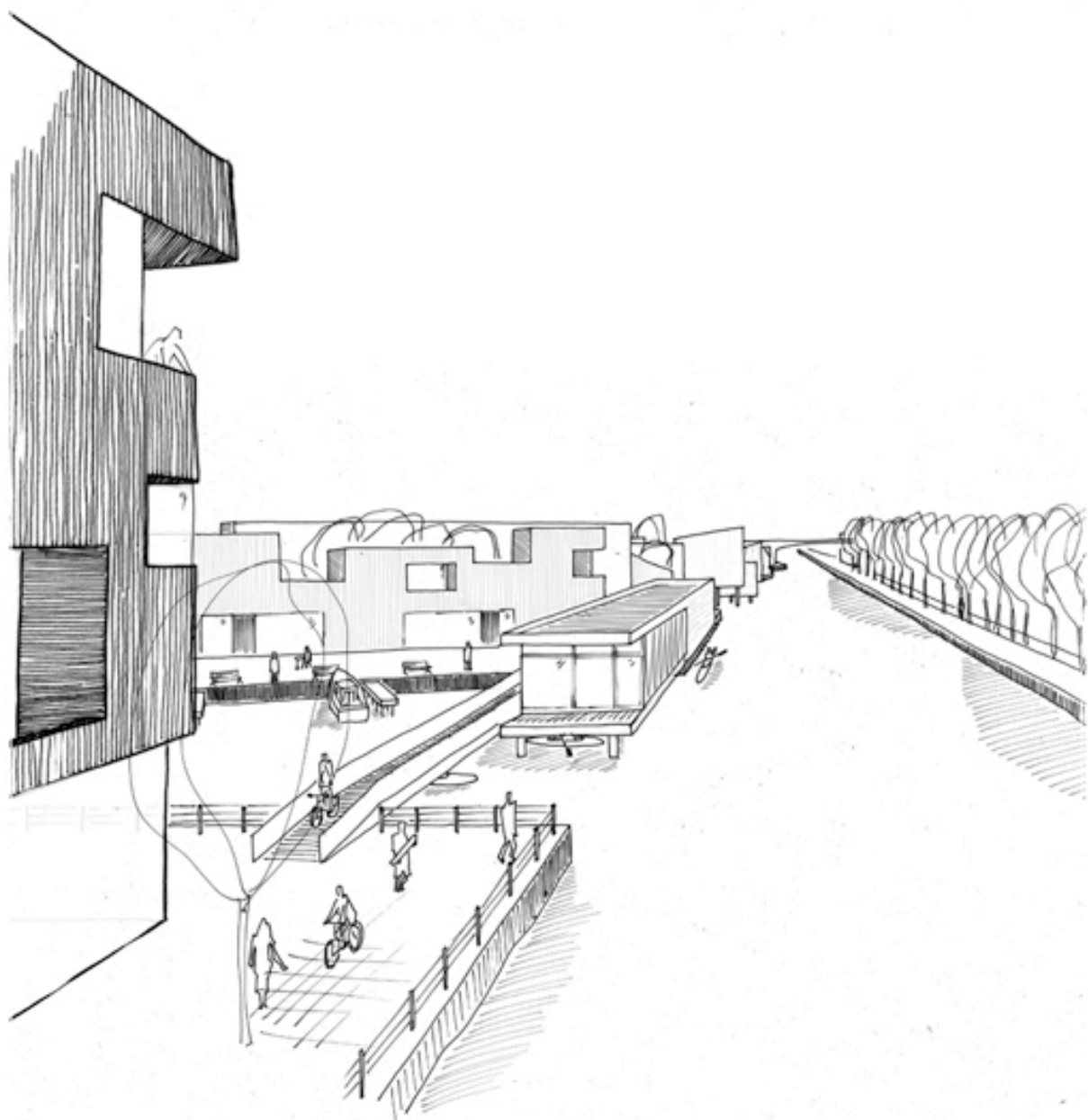



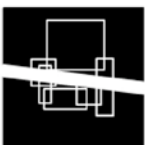

## **Ontwikkelingsscenario's** (deelprojecten)

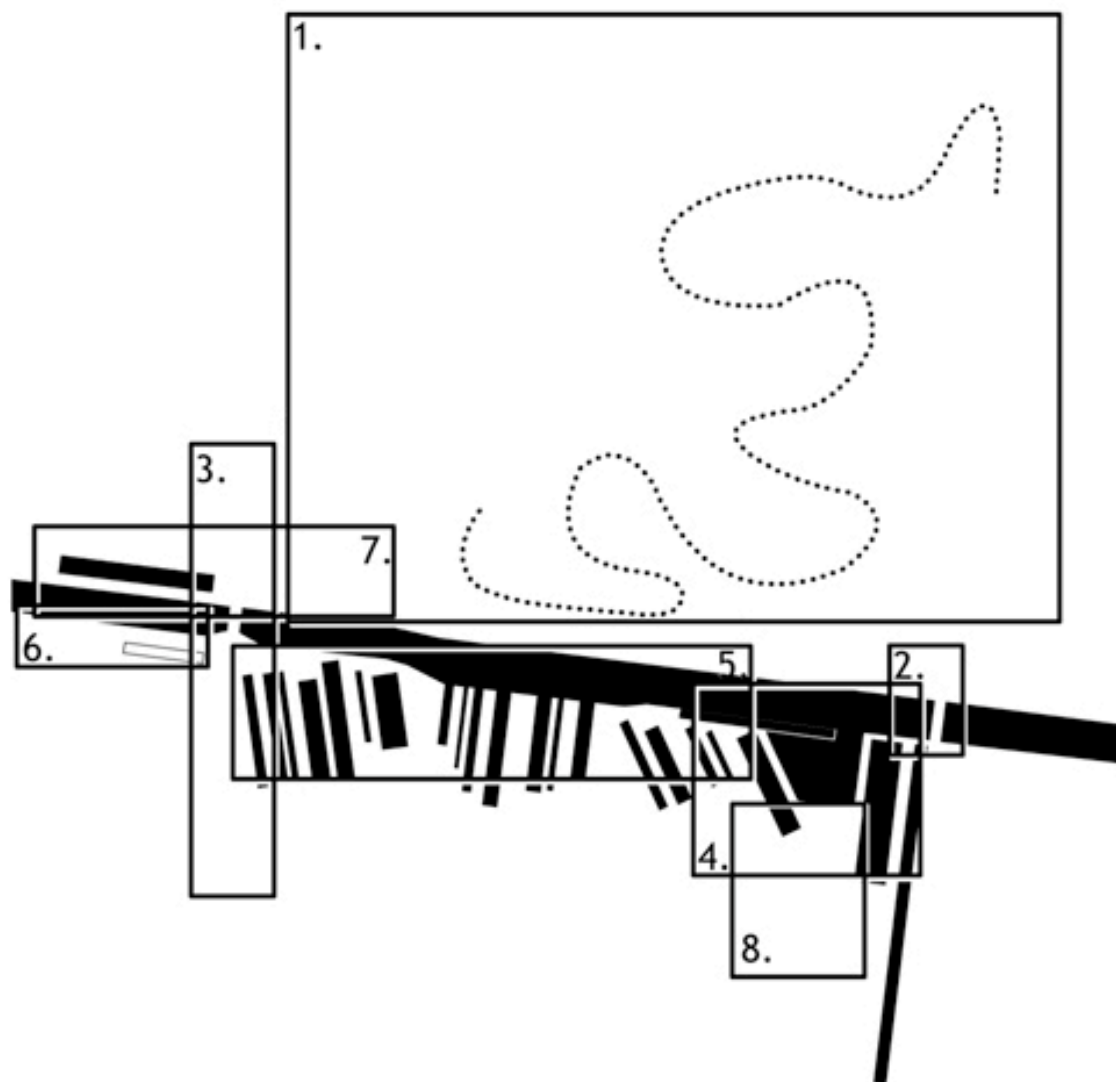

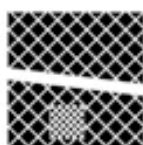

**Objectieve analyse**  
(densiteit en grondgebruik)



**Subjectieve analyse**  
(foto's)

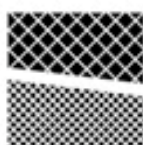

**Stellingname**  
(landschap vs stedelijkheid)

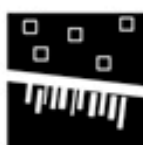

**Ruimtelijke strategie**  
(stip vs strip)

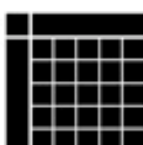

**Instrumentarium**  
(beheersconstructie vs matrix)



**Eindbeeld**  
(perspectief)



**Ontwikkelingsscenario's**  
(deelprojecten)



jun 2008

M D W D V Z Z

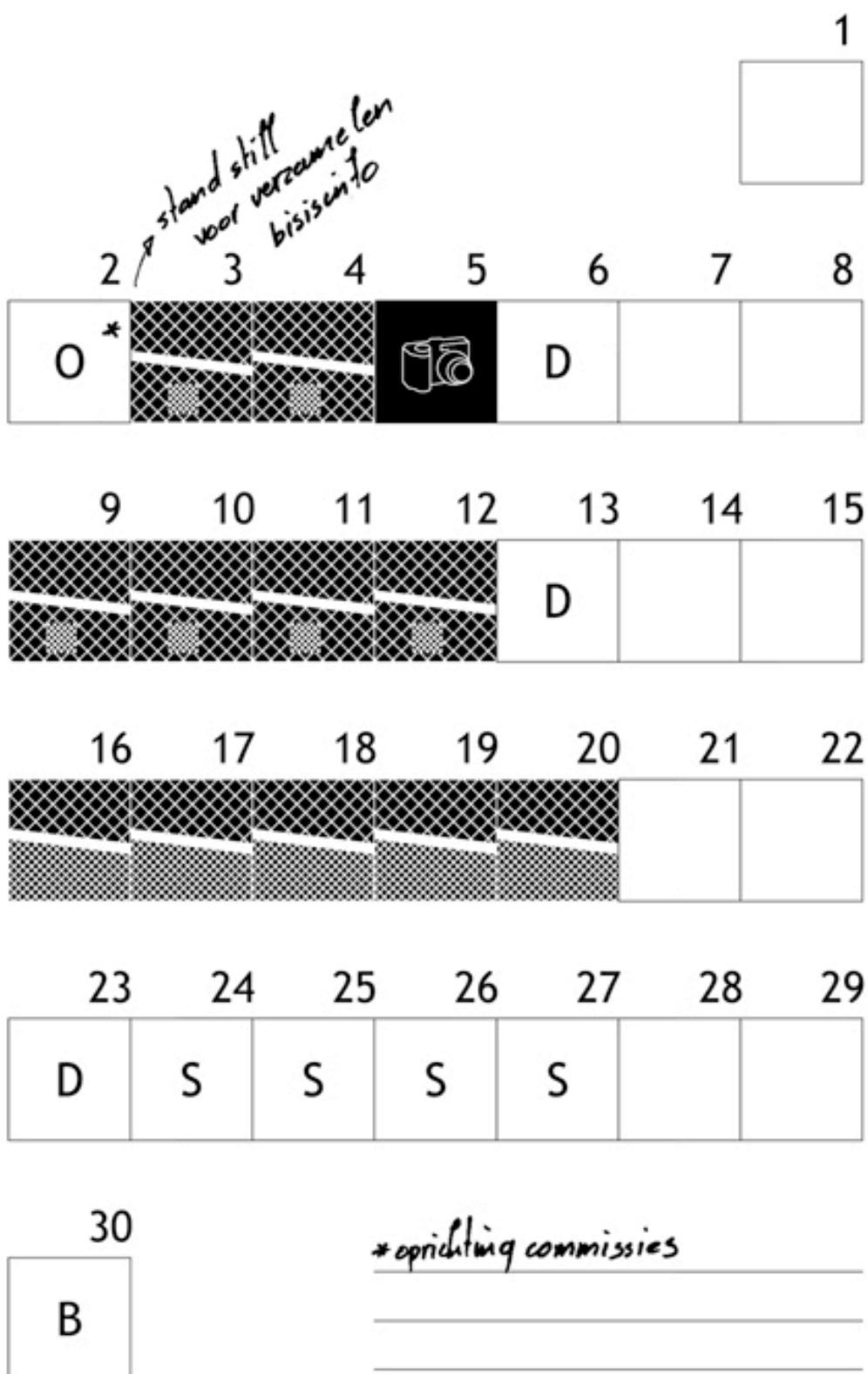

FASE 1

jul 2008

M D W D V Z Z

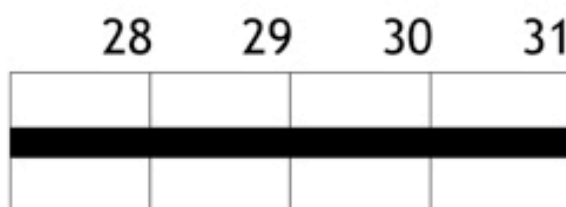
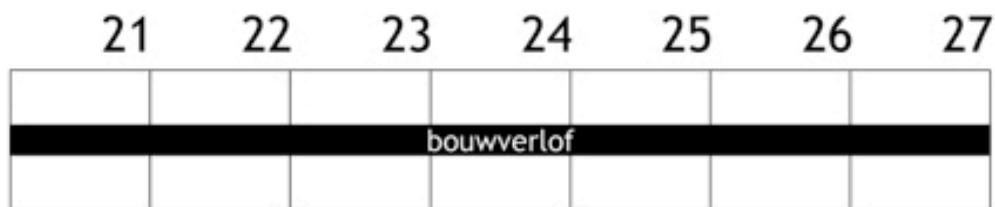
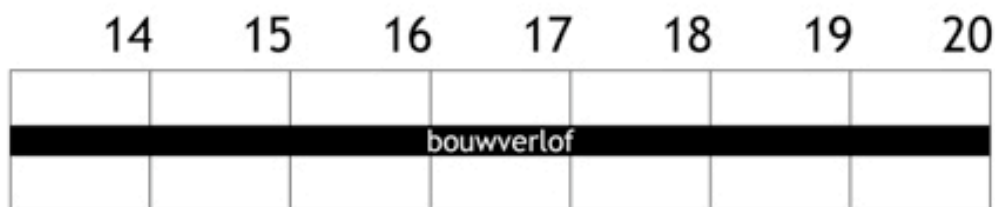
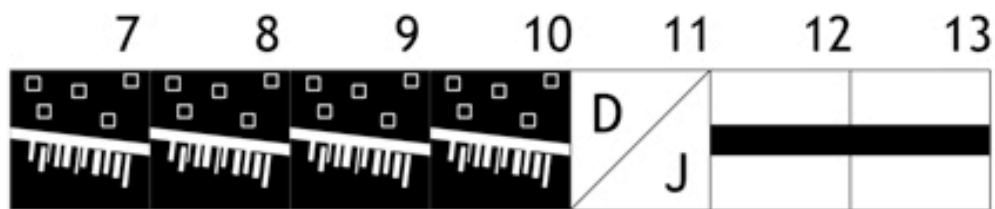
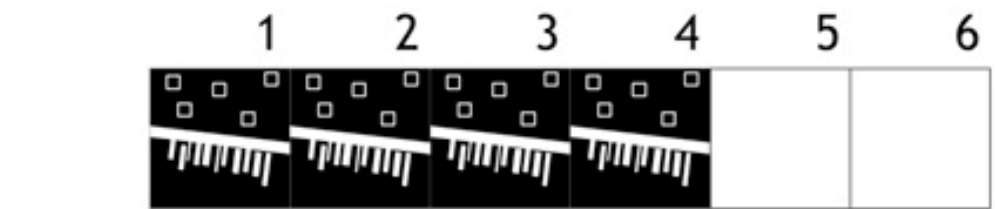

---

---

---

FASE 2

O: opstartvergadering

D: denkcomissie

J: juridische adviescomissie

aug 2008

M D W D V Z Z

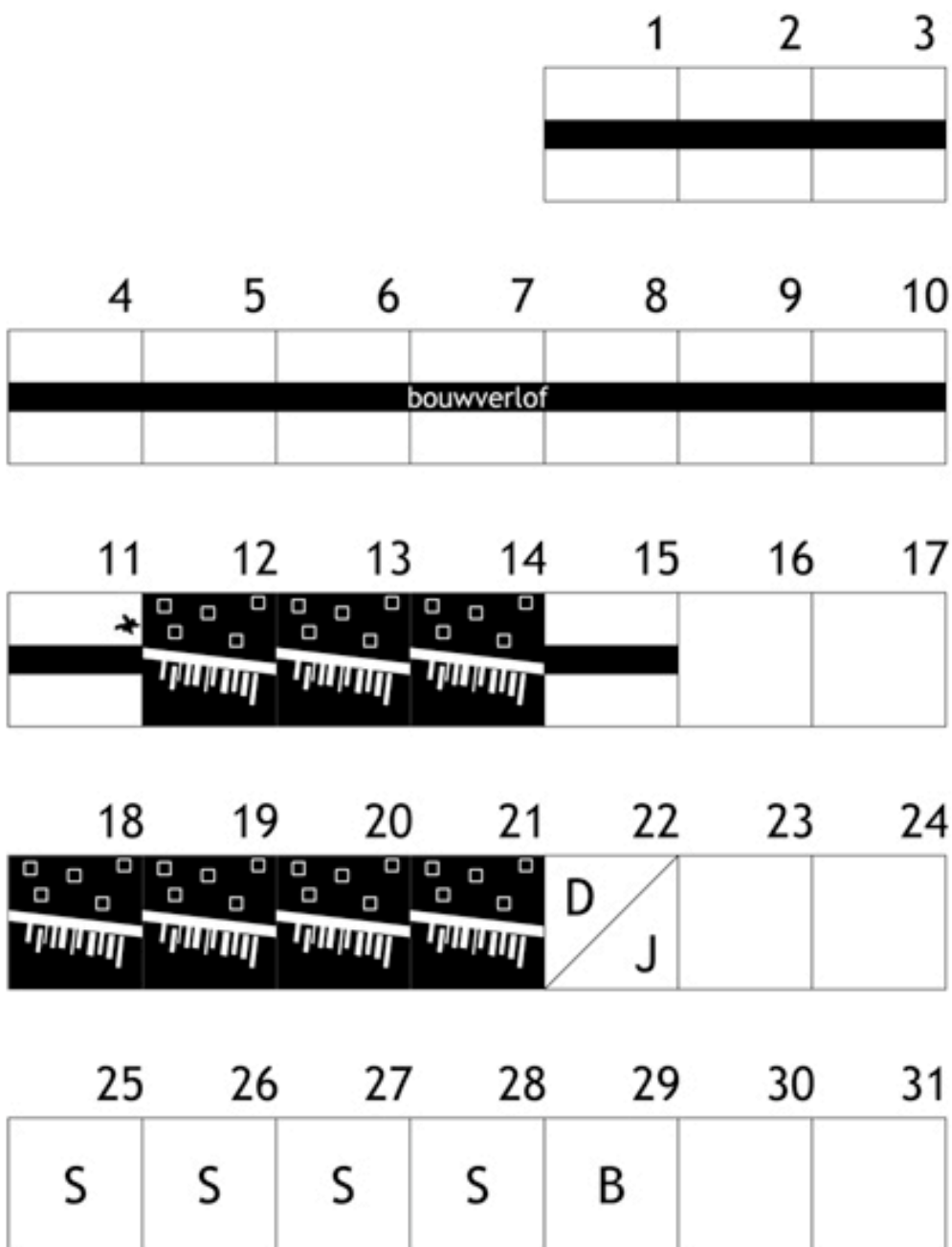

\*compensatie 21 juli

FASE 2



sep 2008

M D W D V Z Z

1 2 3 4 5 6 7

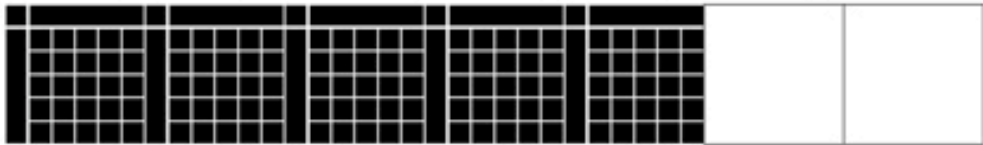

8 9 10 11 12 13 14

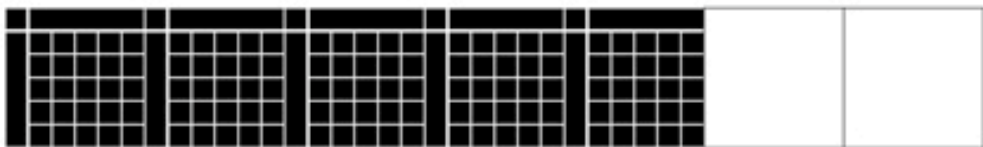

15 16 17 18 19 20 21



22 23 24 25 26 27 28



29 30

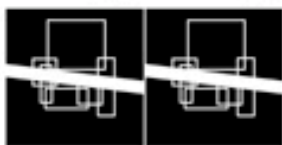

---

---

---

-FASE 3-

O: opstartvergadering

D: denkcomissie

J: juridische adviescomissie

okt 2008

M D W D V Z Z

		1	2	3	4	5
				J		
6	7	8	9	10	11	12
S	S	S	S	S		
13	14	15	16	17	18	19
S	S	S	S	D J		
20	21	22	23	24	25	26
S	S	S	S	S		
27	28	29	30			
B	S	S	PC			

---

---

---

FASE 3





1 ————— werkdagen ————— 44

